

D Termination Bar Detail
3" = 1'-0"

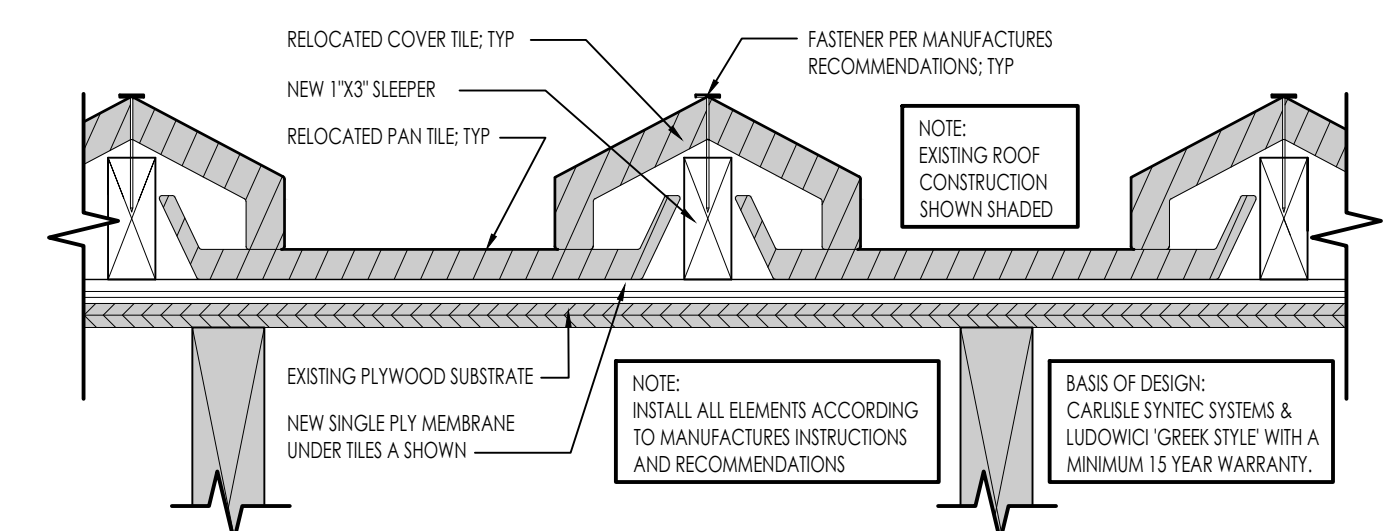

C Tile Detail
3" = 1'-0"

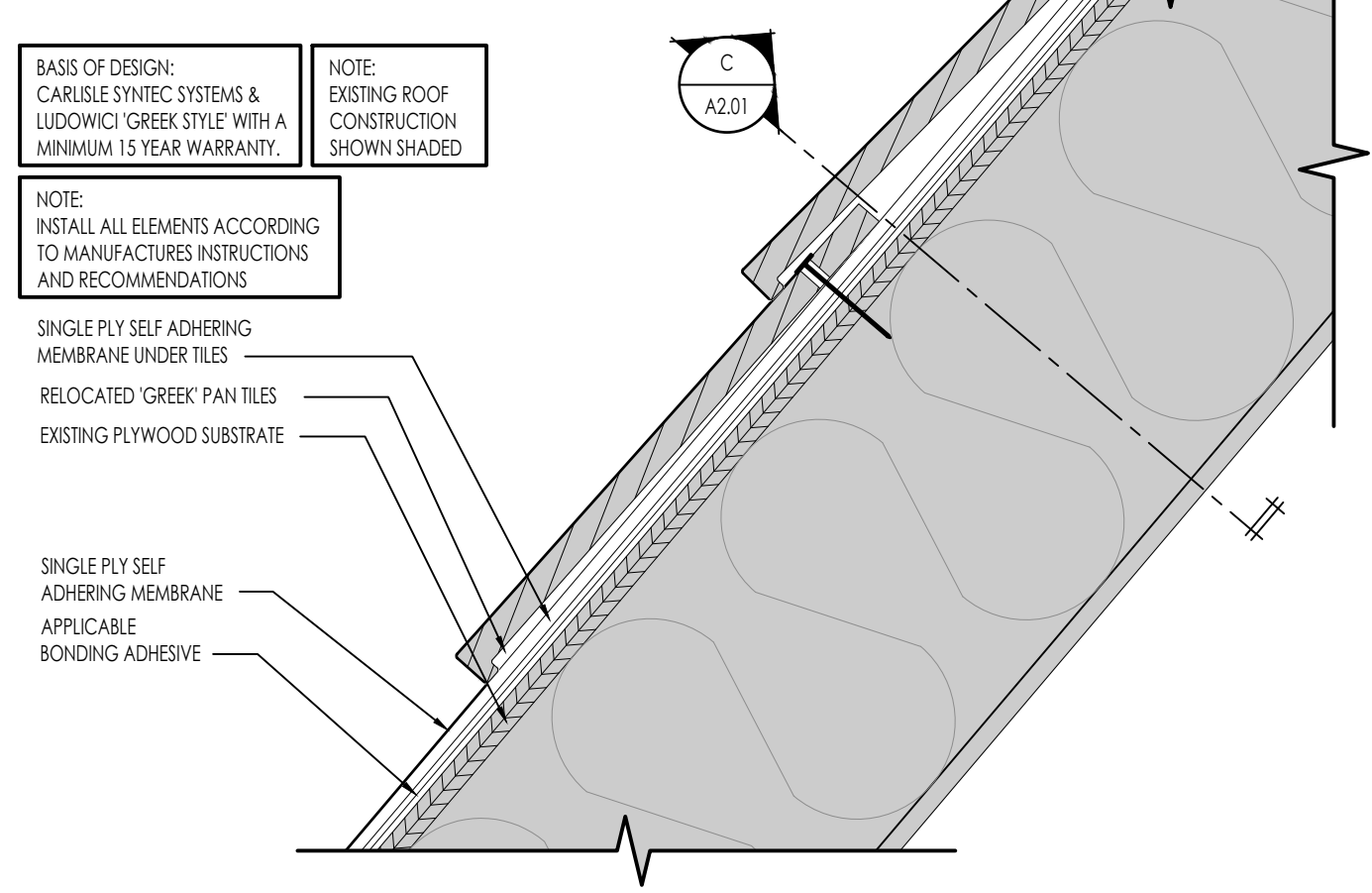

B Pan Tile Detail (Bid Alt 'A')
3" = 1'-0"

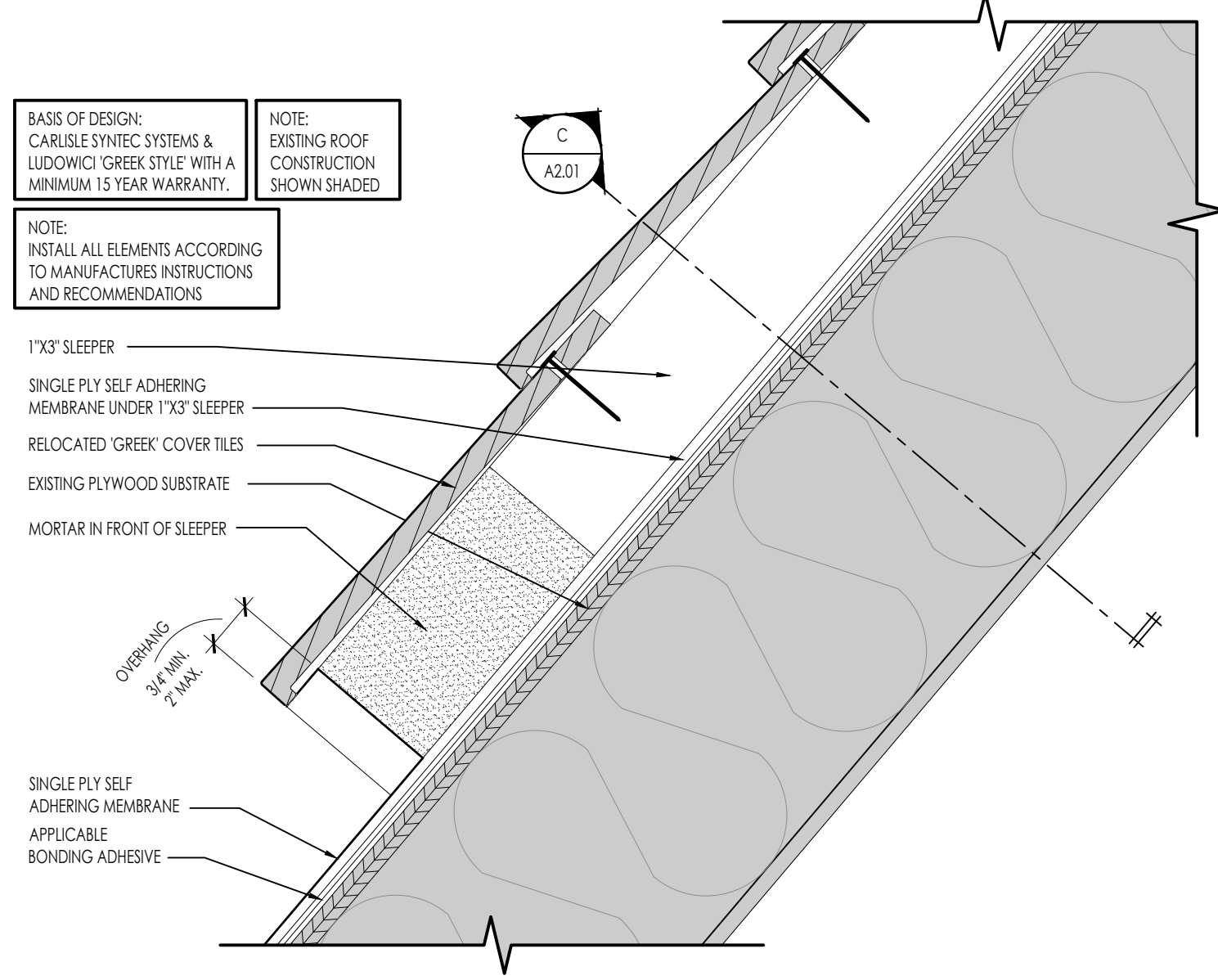

F Cover Tile Detail (Bid Alt 'A')
3" = 1'-0"

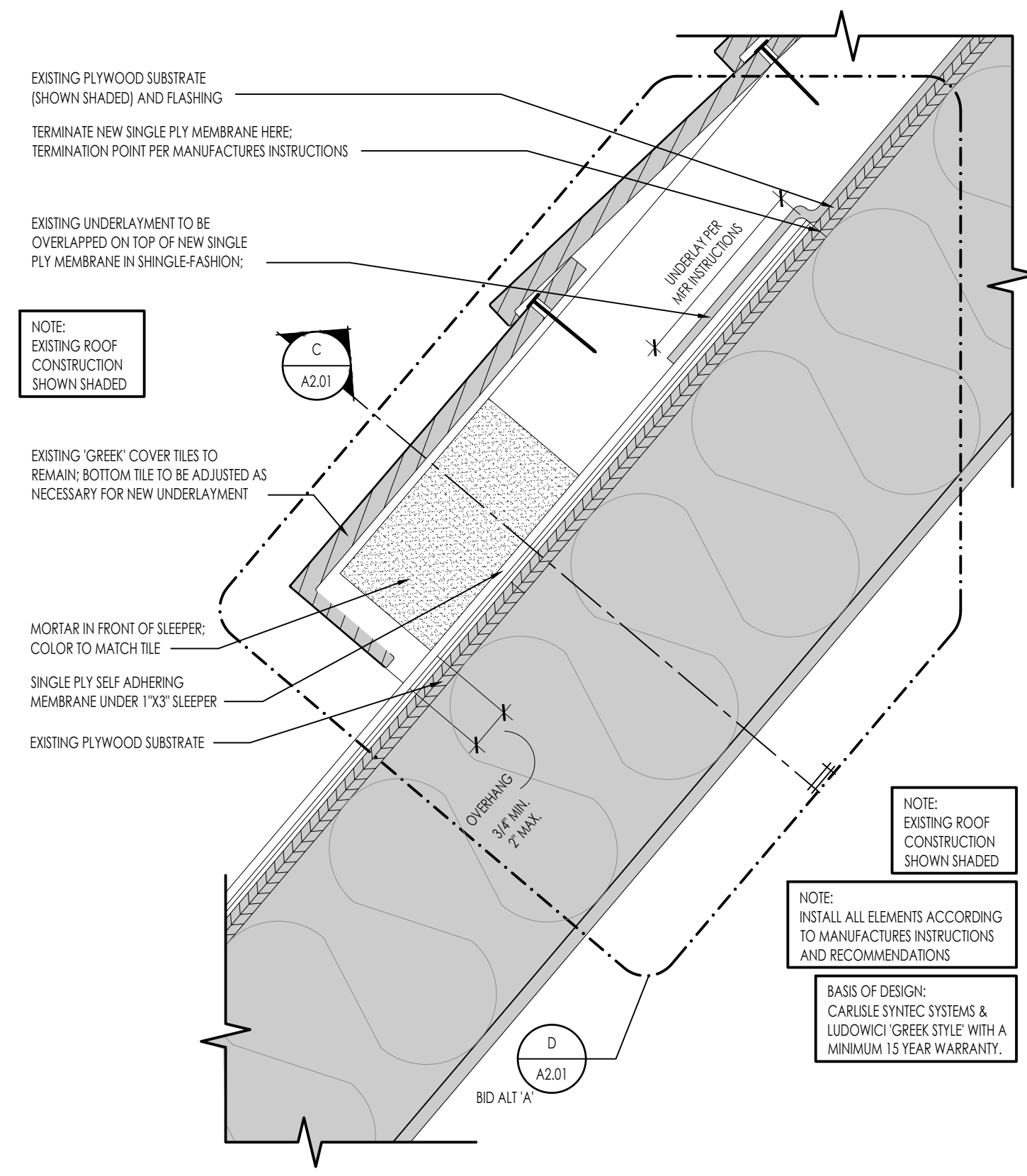

E Cover Tile Detail
3" = 1'-0"

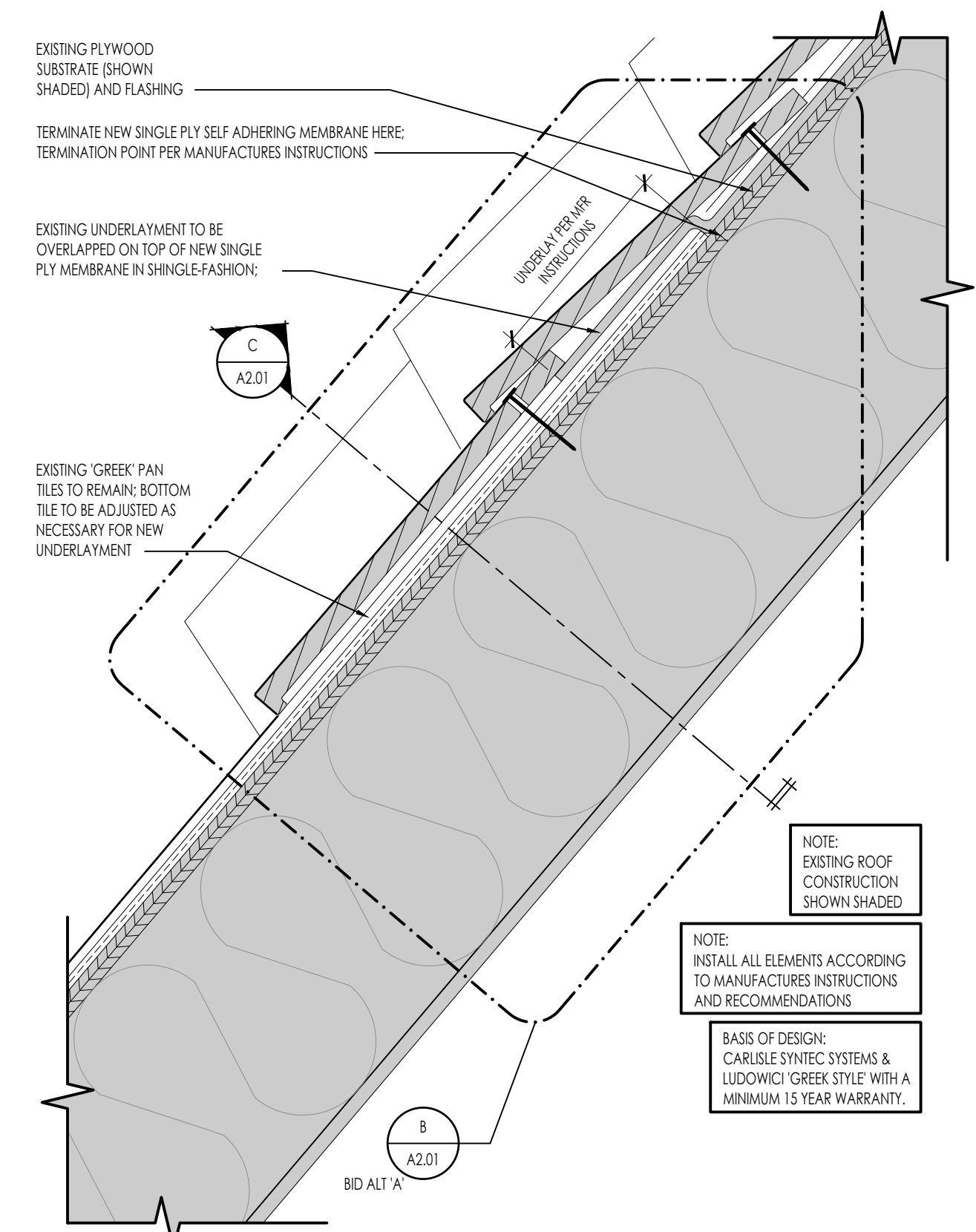

A Pan Tile Detail
3" = 1'-0"

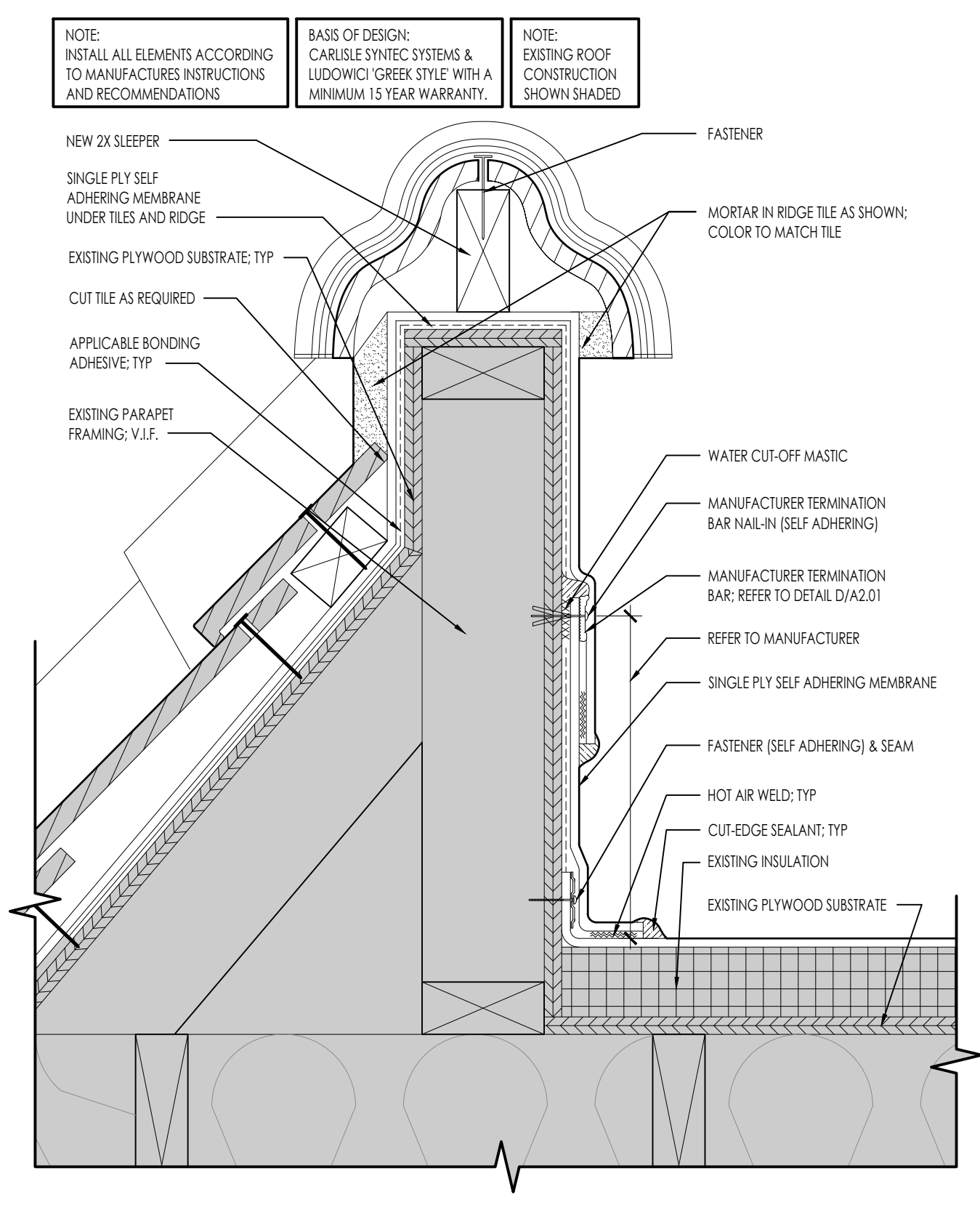

K Ridge Tile Detail (Bid Alt 'A')
3" = 1'-0"

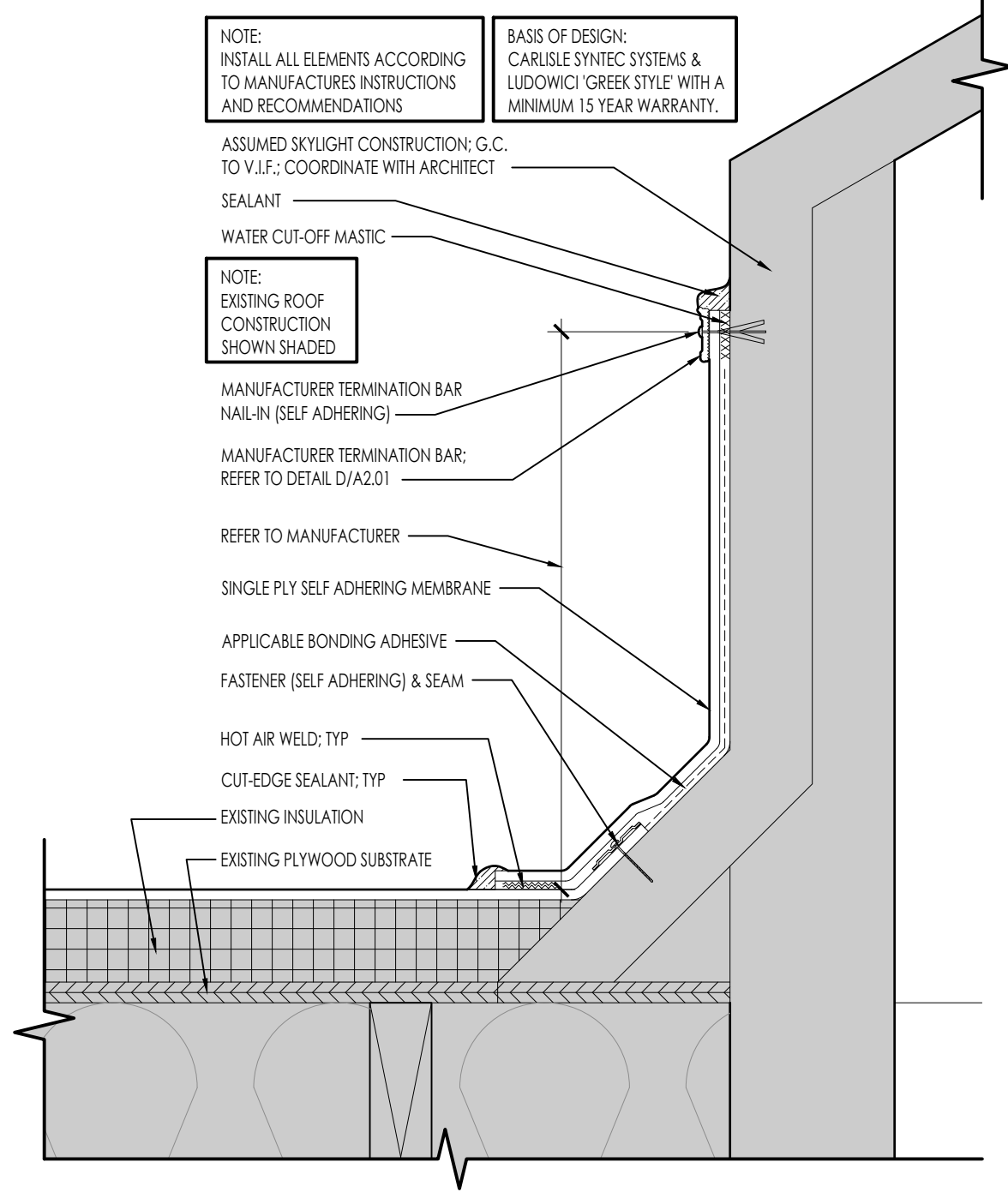

H Skylight Detail (Bid Alt 'A')
3" = 1'-0"

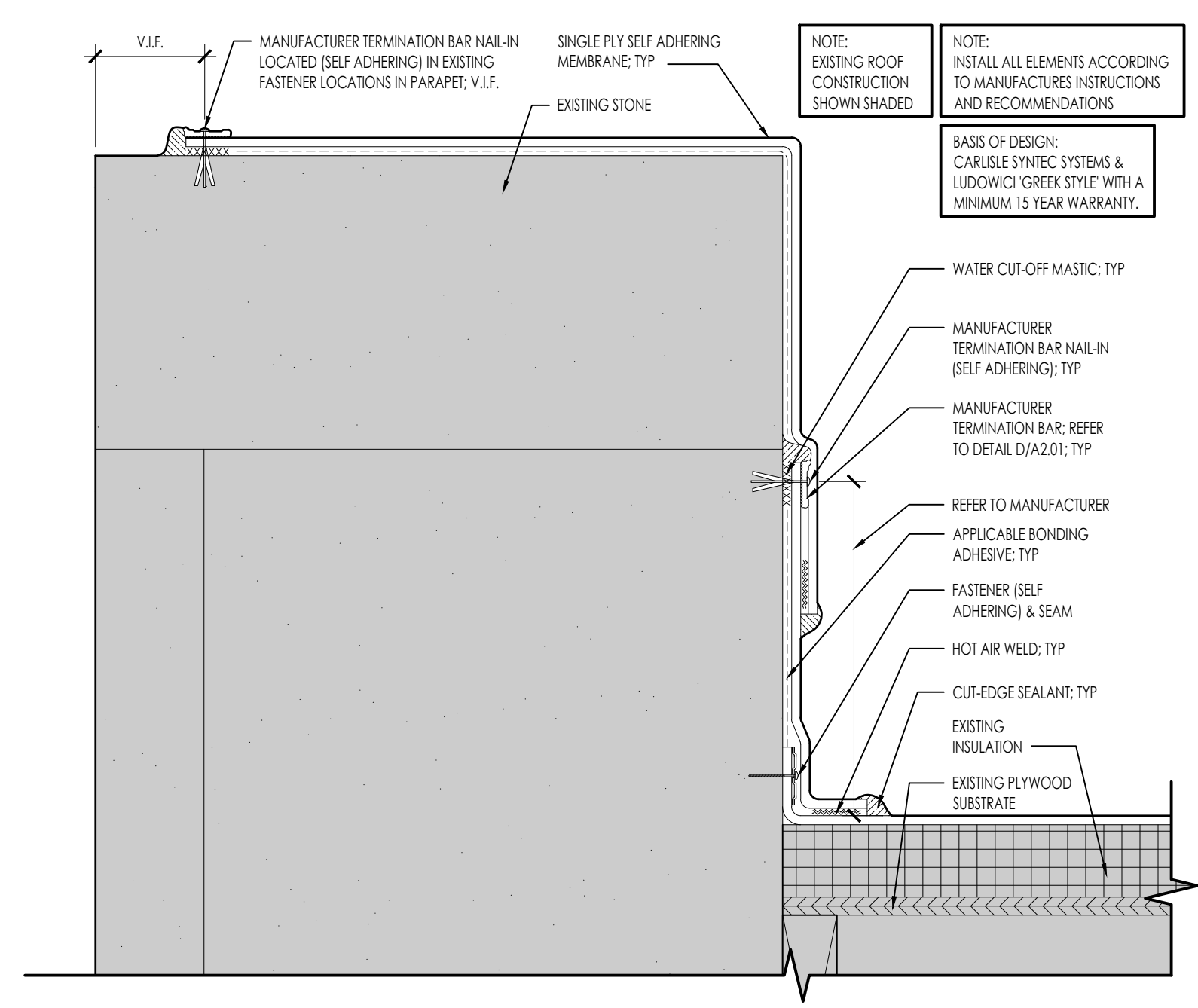

J Parapet Detail
3" = 1'-0"

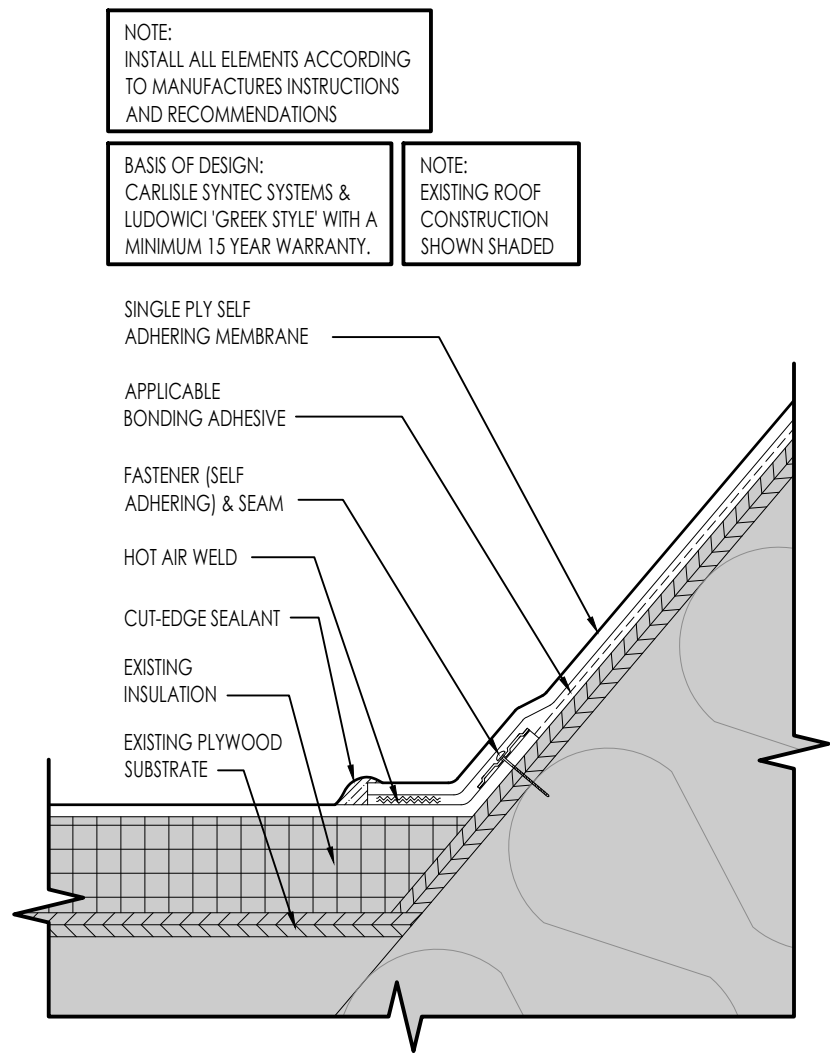

G Roof Detail
3" = 1'-0"

NOTE: INSTALL ALL ELEMENTS ACCORDING TO MANUFACTURER'S INSTRUCTIONS AND RECOMMENDATIONS.

BASIS OF DESIGN: CARLISLE SYNTEC SYSTEMS & LUDOWICI 'GREEK STYLE' WITH A MINIMUM 15 YEAR WARRANTY.

NOTE: EXISTING ROOF CONSTRUCTION SHOWN SHADED.

NOTE: INSTALL ALL ELEMENTS ACCORDING TO MANUFACTURER'S INSTRUCTIONS AND RECOMMENDATIONS.

BASIS OF DESIGN: CARLISLE SYNTEC SYSTEMS & LUDOWICI 'GREEK STYLE' WITH A MINIMUM 15 YEAR WARRANTY.

NOTE: EXISTING ROOF CONSTRUCTION SHOWN SHADED.

BASIS OF DESIGN: CARLISLE SYNTEC SYSTEMS & LUDOWICI 'GREEK STYLE' WITH A MINIMUM 15 YEAR WARRANTY.

NOTE: EXISTING ROOF CONSTRUCTION SHOWN SHADED.

NOTE: INSTALL ALL ELEMENTS ACCORDING TO MANUFACTURER'S INSTRUCTIONS AND RECOMMENDATIONS.

BASIS OF DESIGN: CARLISLE SYNTEC SYSTEMS & LUDOWICI 'GREEK STYLE' WITH A MINIMUM 15 YEAR WARRANTY.

NOTE: EXISTING ROOF CONSTRUCTION SHOWN SHADED.

NOTE: INSTALL ALL ELEMENTS ACCORDING TO MANUFACTURER'S INSTRUCTIONS AND RECOMMENDATIONS.

NOTE: EXISTING ROOF CONSTRUCTION SHOWN SHADED.

NOTE: INSTALL ALL ELEMENTS ACCORDING TO MANUFACTURER'S INSTRUCTIONS AND RECOMMENDATIONS.

BASIS OF DESIGN: CARLISLE SYNTEC SYSTEMS & LUDOWICI 'GREEK STYLE' WITH A MINIMUM 15 YEAR WARRANTY.

NOTE: INSTALL ALL ELEMENTS ACCORDING TO MANUFACTURER'S INSTRUCTIONS AND RECOMMENDATIONS.

BASIS OF DESIGN: CARLISLE SYNTEC SYSTEMS & LUDOWICI 'GREEK STYLE' WITH A MINIMUM 15 YEAR WARRANTY.

NOTE: EXISTING ROOF CONSTRUCTION SHOWN SHADED.

NOTE: EXISTING ROOF CONSTRUCTION SHOWN SHADED.

NOTE: EXISTING 'GREEK' COVER TILES TO REMAIN. BOTTOM TILE TO BE ADJUSTED AS NECESSARY FOR NEW UNDERLAYMENT.

NOTE: EXISTING ROOF CONSTRUCTION SHOWN SHADED.

NOTE: INSTALL ALL ELEMENTS ACCORDING TO MANUFACTURER'S INSTRUCTIONS AND RECOMMENDATIONS.

BASIS OF DESIGN: CARLISLE SYNTEC SYSTEMS & LUDOWICI 'GREEK STYLE' WITH A MINIMUM 15 YEAR WARRANTY.

NOTE: EXISTING ROOF CONSTRUCTION SHOWN SHADED.

NOTE: INSTALL ALL ELEMENTS ACCORDING TO MANUFACTURER'S INSTRUCTIONS AND RECOMMENDATIONS.

BASIS OF DESIGN: CARLISLE SYNTEC SYSTEMS & LUDOWICI 'GREEK STYLE' WITH A MINIMUM 15 YEAR WARRANTY.